

Approve
CEO Glassica CJSC
Kazimov Eldar _____

Developer
Nanii Leonid _____

CJSC "Glassica"

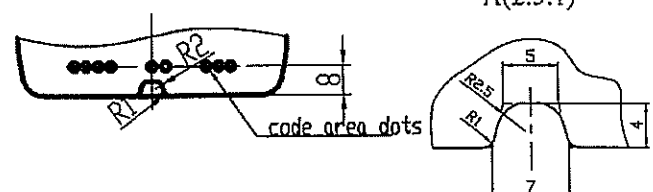
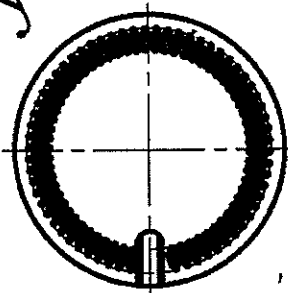
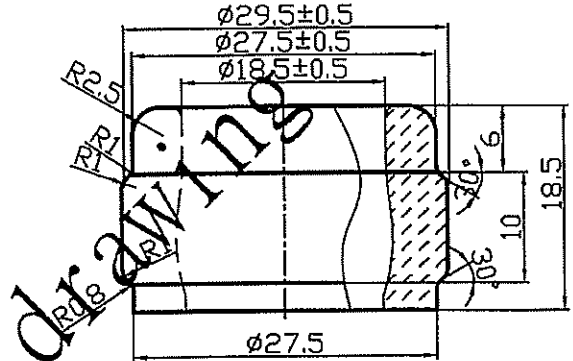
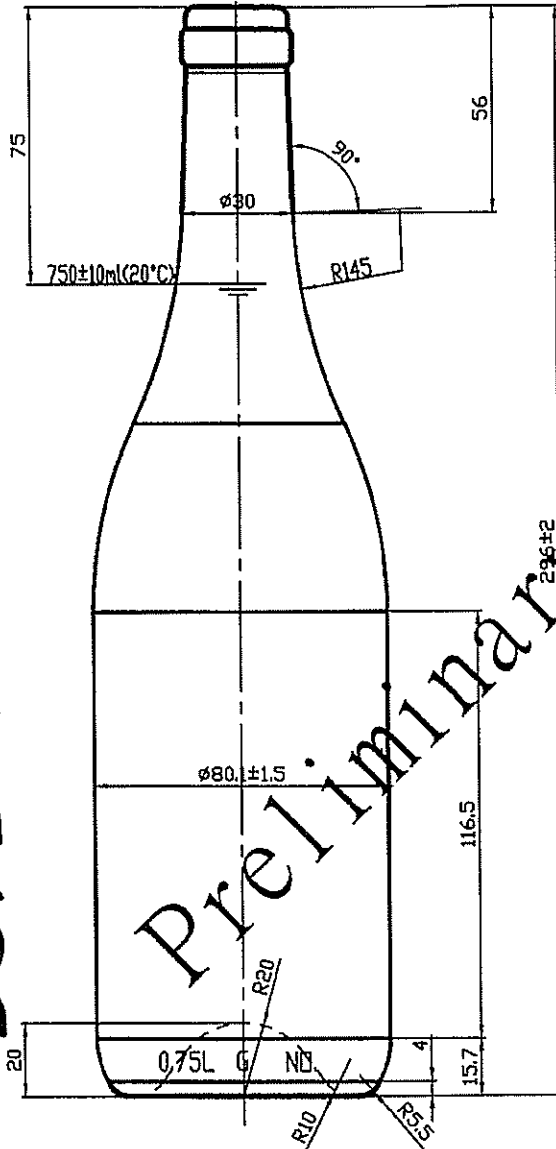

Technical data of item

Nominal capacity at H=75mm, cm³ -75cl±1cl
Glass weight - 450 gr.
Glass color -FLINT, GREEN

Packing data:

Quantity per pallet- 1078 pcs.
Quantity per truck- 34496 pcs./32p
Dimension of pallet-1200x800

Seller's approval _____

Buyer's approval _____

The controllable dimensions of a glass finish FACETA 29.5H16: $\phi 29.5 \pm 0.5$; $\phi 27.5 \pm 0.5$; $\phi 18.5 \pm 0.5$ must be on the depth - 3 mm;

$\phi 17.5$ min through bore

The controllable dimensions of a glass body:

$\phi 80.1 \pm 1.5$; 296 ± 2

Thickness of glass bottle walls, min-1.2 mm

Thickness of glass bottle bottom, min - 2.4 mm

Termoshock, min - 40°C

Pressure, min - 5bar/60±2 sec

Item: "Burgundy GLS P-29.5-A-750"